



**HEAVY DUTY
FOOD
SERVICE
TAPWARE
FOR
COMMERCIAL
KITCHENS**



Food Service Tapware



Enware Australia's range of food service tapware provides a comprehensive selection of heavy duty fittings to meet most commercial and institutional kitchen requirements.

Manufactured in Australia to conform with Australian and International standards, the design of fittings allow a full interchange of assemblies between valves, risers and outlets creating a selection of pre-rinse assemblies, pot fillers and other general purpose fittings. This range has been designed to ensure customer requirements can be met effectively and quickly. Further specialised fittings may be made to customer specifications if not already detailed in this brochure.

Hob Mounted Assemblies

All hob mounted Food Service units include 1/2" BSP Male connections. Overall height can be adjusted, contact Enware for more information.

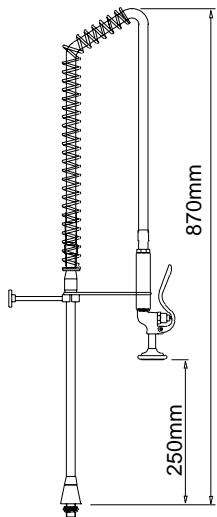

Riser Assembly / Spring Return
Product Code: **FHS 001**
With pot filler: **FHS 101**

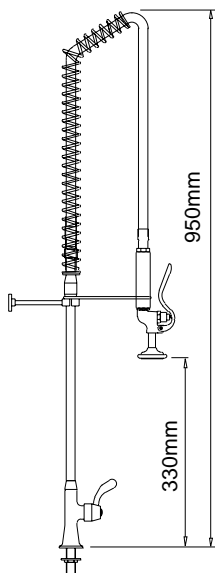

Pre-Mixer Assembly / Swivel Arm
Product Code: **FHS 011**
With pot filler: **FHS 111**

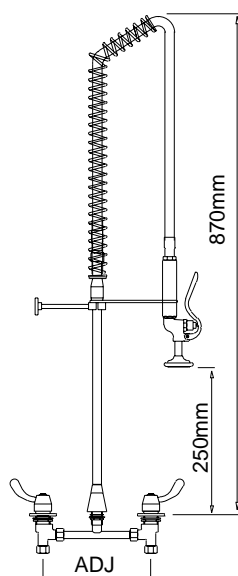

Concealed Mixer Assembly / Spring Return
Product Code: **FHS 021**
With pot filler: **FHS 121**

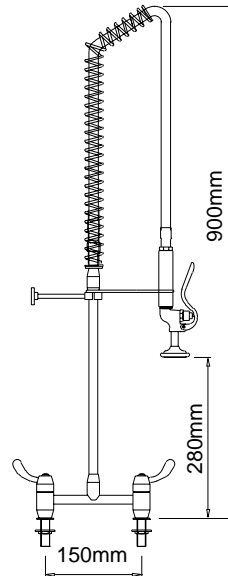

Exposed Mixer Assembly / Spring Return
Product Code: **FHS 031**
With pot filler: **FHS 131**
*215mm width or adjustable centres are also available.

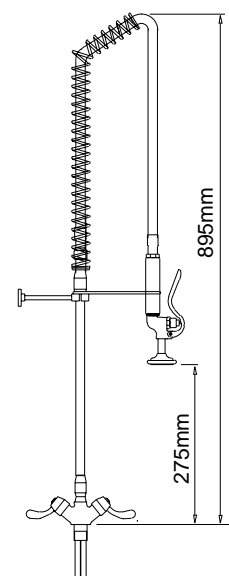

Dual Mixer Assembly / Spring Return
Product Code: **FHS 041**
With pot filler: **FHS 141**

Wall Mounted Assemblies

All wall mounted Food Service units include 1/2" BSP Female connections. Overall height can be adjusted, contact Enware for more information.

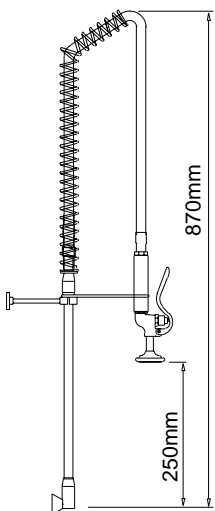

Riser Assembly / Spring Return
Product Code: **FWS 001**
With pot filler: **FWS 101**

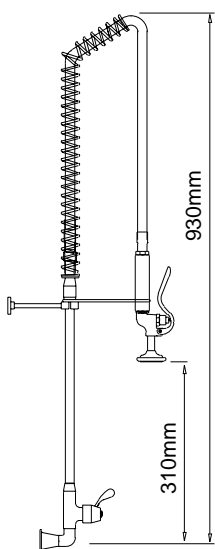

Pre-Mixer Assembly / Swivel Arm
Product Code: **FWS 011**
With pot filler: **FWS 111**

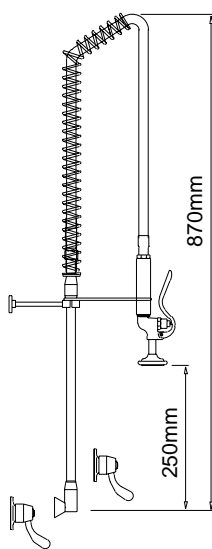

Concealed Mixer Assembly / Spring Return
Product Code: **FWS 021**
With pot filler: **FWS 121**

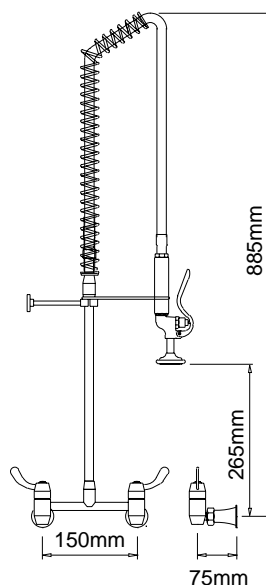

Exposed Mixer Assembly / Spring Return
Product Code: **FWS 031**
With pot filler: **FWS 131**
*215mm width or adjustable centres are also available.

Optional: Pot Filler Adaptor available for all assemblies. (note overall height is increased by **120mm**)

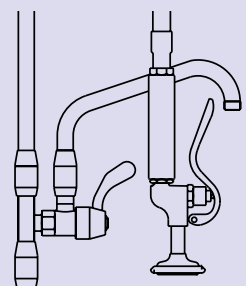

To include the Pot Filler option the first number in the product code changes from 0 to 1
eg. FHS 001 becomes FHS101 with a pot filler

Options and Parts

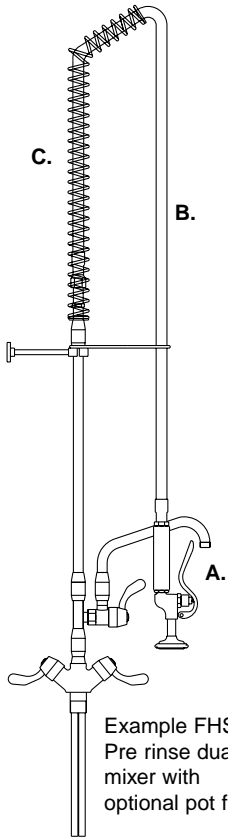

Example FHS141
Pre rinse dual
mixer with
optional pot filler.

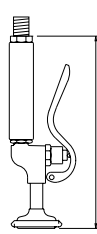

A. TRIGGER SPRAY
Part no: **FS 721**

A full compliment of spare parts and service advice is available from Enware for all products in this range. For optimum performance it is recommended that the control valves be turned off when not in use overnight or for long periods.

The robust trigger spray incorporates a dual check valve in the outlet to prevent back siphonage. The rubber spray guard minimises the risk of tile damage if in contact with the wall.

Quarter turn non-rising jumper valve assemblies used in conjunction with 65mm expo handles allow for easy control of water.



B. FOOD GRADE 2 WIRE HOSE

FS 104: 400mm WITH BSP 15mm
FS 106: 600mm WITH BSP 15mm
FS 109: 900mm WITH BSP 15mm

FS 110: 1000mm WITH BSP 15mm
FS 111: 1100mm WITH BSP 15mm
FS 115: 1500mm WITH BSP 15mm

For special lengths contact Enware

C. ASSEMBLY PARTS

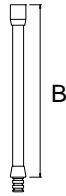

RISER
FS 053: 300mm (standard)
FS 056: 600mm(optional)
FS 059: 900mm(optional)

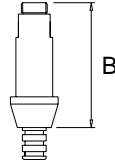

SPRING RETAINER
FS 061: 90mm

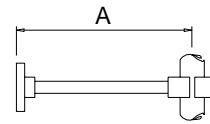

ADJUSTABLE WALL BRACKET
FS 070: A 40-150mm



SPRING RETURN
FS 100
Smaller spring available

HOB RISER BASES - 1/2" BSP male connections

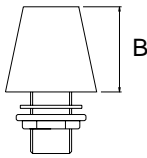

HOB RISER BASE
FS 010: B: 40mm

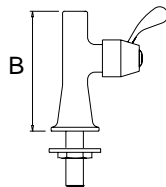

HOB PRE MIXER
FS 011: B: 130mm

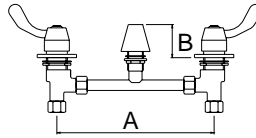

HOB CONCEALED MIXER
FS 013:
A: 140 - 230mm B: 40mm

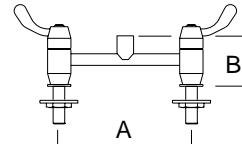

HOB EXPOSED MIXER
FS 012:
A: 150mm B: 290mm
*215mm width or adjustable centres are also available.

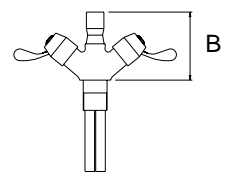

HOB DUAL MIXER
FS 015: B: 80mm

WALL RISER BASES - 1/2" BSP female connections

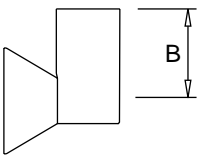

WALL RISER BASE
FS 020: B 40mm

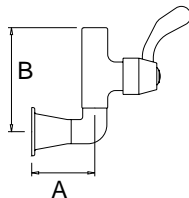

WALL PRE MIXER
FS 021: A 80mm B 100mm

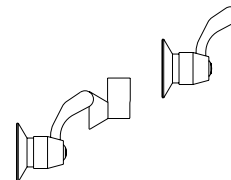

WALL MIXER SET
FS 023

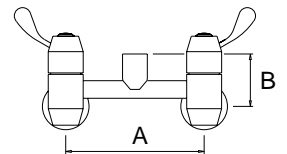

WALL EXPOSED MIXER
FS 022: A 150mm B 90mm
*215mm width or adjustable centres are also available.

SPOUT OPTIONS

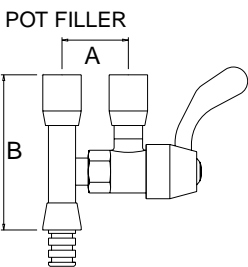

FS 063: A 45mm B 120mm

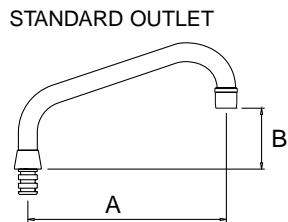

FS 180: 180mm 70mm
FS 181: 230mm 95mm
FS 182: 300mm 110mm
With aerator

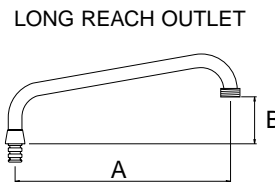

FS 188: 150mm 50mm
FS 187: 300mm 80mm
With 1/2" BSP thread

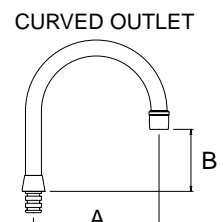

FS 184: 150mm 100mm
FS 185: 200mm 90mm
With aerator

Hygienic Tapware Solutions

In keeping with hygiene demands in all food preparation areas, Enware offers a range of hands free control options, including elbow, foot, knee, or electronic operation to minimise cross contamination from hand contact.



WALL ELECTRONIC EMB802

"No touch" user friendly electronic sensor activated tapware. Stainless steel fascia available for vandal & "knock" resistance.



TYPE 51 WALL LEVER MIXING SET HOS402

A wide range of lever action tapware for elbow operation. Refer to our Lever Action brochure.



BENCH ELECTRONIC EMB801

Basin mounted, hygienic "no touch" sensor operation. Available in bright chrome & satin chrome finish.

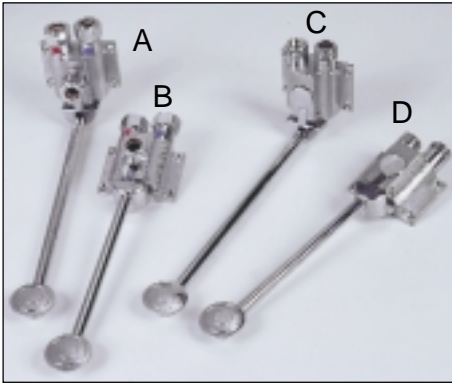

FOOT OPERATED PEDAL VALVES

Pedal valves with single or mixing water control for wall or floor mountings.

- A: **TFC 739 W** (Hot & cold inlet valve - Wall)
- B: **TFC 739 F** (Hot & cold inlet valve - Floor)
- C: **TFC 736 W** (single inlet valve - Wall)
- D: **TFC 736 F** (single inlet valve - Floor)



HYDROPATHIC UNIT HHU2000

The Waterware hands hygiene station provides a complete hands free cycle including soap dispensing. The unit also includes a counter so shift effectiveness can be measured.

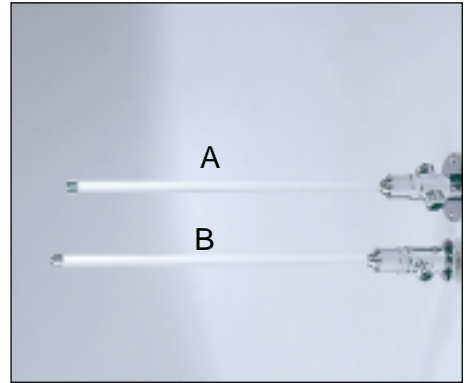

KNEE OPERATION

The convenience and practicality of hands free operation with 15 seconds self closing time delay.

- A: **TFC 735** (Straight through valve)
- B: **TFC 734** (90° valve)

*Spring action also available.

Refreshing Chilled Water & Convenient Boiling Water



Provide refreshing chilled water with the Waterware range of free standing and under counter units. Filter options are also available.



Provide the convenience of Waterware instant boiling water units. These wall mounted units are available in 3 capacities to suit demand and feature an easy action push button control with a splash minimising delivery spout.